

# EX - PLUG AND RECEPTACLE

## 16 A Metallic Design for Zone 1

The explosion-protected light metal plug and receptacle devices can be used in the areas of Zone 1 and Zone 2 at no risk of explosion. Extremely harsh conditions of use in the hazardous area requires the devices to have highest mechanical strength. The explosion-protected CEAG plug and socket devices can be used to supply the appropriate energy to portable electrical equipment in these harsh conditions.

The robust plug and receptacle devices with high-quality cast aluminium housings can be connected to a large connecting room via explosion-proof conduits or explosion-proof screwed connections.

Unused flameproof threads for cable glands have to be closed with certified plugs.

The light metal plug and socket devices have an outside earthing connection.

The explosion-protected plug can be plugged into an industrial sockets if their contact disposability is acc. to IEC 60309 connecting terminals are in an Ex-e chamber, all other parts are Ex-d protected.



- Ex-d enclosure
- High mechanical, chemical and thermal resistance conduit
- Connecting technology

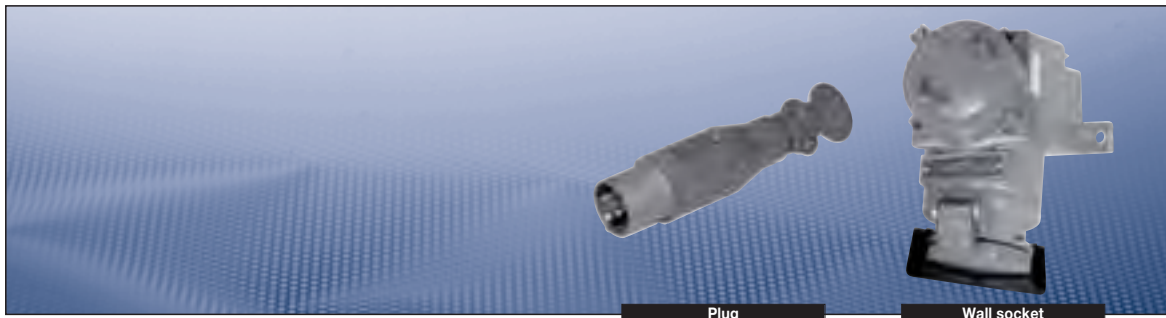

Plug

Wall socket

### Technical data

#### Ex-protected plug and socket Ex d

Marking to 94/9/EC	⊕ II 2 G Ex de IIC T6
EC-Type Examination Certificate	LOM 03 ATEX 2019
Permissible ambient temperature	-20 °C up to +55 °C
Rated voltage	see ordering details
Rated current	16 A
Frequency	50/60 Hz
Rated making/rated breaking capacity AC-3 accd. EN 60947-3	U <sub>e</sub> 415 V / I <sub>e</sub> 16 A
External back-up fuse, max.	without therm. protection: 16 A / with therm. protection: 35 A gL
Degree of protection to EN 60529	IP65
Enclosure material	Light alloy, polyester paint finish

#### Wall socket

Cable glands	2 x 3/4", ISO 7/1, one plugged
Connecting terminals	2 x 1.0 - 2.5 mm <sup>2</sup>

#### Plug

Cabel glands	Ø 8.5 - 13.5 mm
Connecting terminals	1 x 1.0 - 2.5 mm <sup>2</sup> / PE: 1 x 1.5 - 6 mm <sup>2</sup>

### Ordering details

Voltage <sup>1)</sup>	h	Type	Weight approx.	Order No.
<b>Type 16 A 3-pole</b>				
220 - 250 V	6	Wall socket	2.7 kg	NOR 000 003 230 016
	6	Plug	0.55 kg	NOR 000 003 230 058
<b>Type 16 A 4-pole</b>				
380 - 415 V	6	Wall socket	2.7 kg	NOR 000 003 230 024
	6	Plug	0.55 kg	NOR 000 003 230 066
<b>Type 16 A 5-pole</b>				
380 - 415 V	6	Wall socket	2.7 kg	NOR 000 003 230 032
	6	Plug	0.7 kg	NOR 000 003 230 074

<sup>1)</sup> Other voltages on request

### Dimension drawing

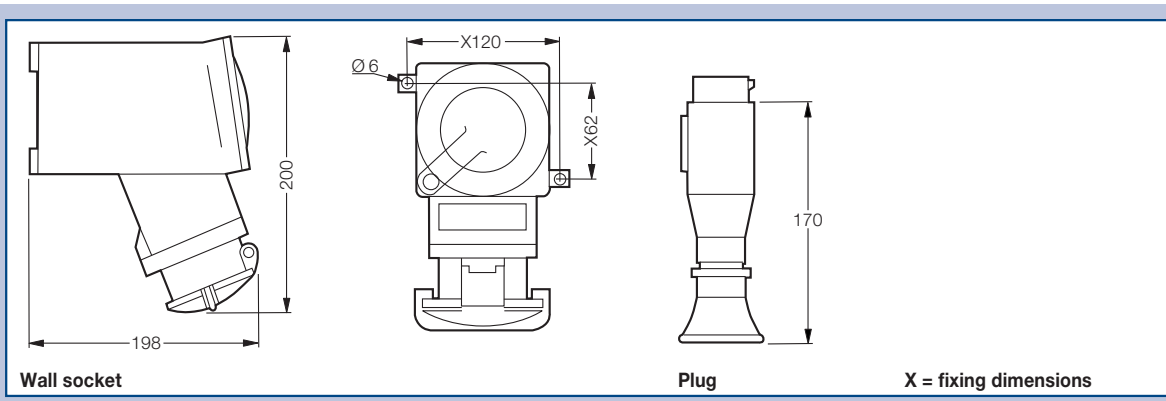

Dimensions in mm

1  
2  
3  
4  
5  
6  
7  
8  
9  
10  
11  
12



# EX - PLUGS AND RECEPTACLES

**16 A to 125 A**  
**Plastic version for Zone 2**

## **A good connection**

Providing electrical energy there, where it is most needed – even in hazardous areas for Zone 2 and Zone 22.

Non-stationary electrical apparatus have generally high requirements on the energy/power supply. Robust plugs and receptacles as well as a high chemical resistance are at the first glance very important. Electrical reliability is a must not only for all connectivity products.

A high safety standard, a steady hold and faultless contacting even under vibration or the effects of an aggressive atmospheric environment are the basis for a secure and reliable utilisation

CEAG plugs and receptacles offer more, apart from the proven technology, this product series is defined by its innovative details. For example, the very efficient cable strain relief or the new coding system of the various versions offers different solutions for a secure and problem free utilization in all areas. Just to round the product off, the user in the normal industrial sector becomes exactly the same product advantages. Robust industrial versions fulfil all requirements appertaining to mechanical and chemical durability. For the stationary repair power supplying in hazardous explosive areas, there is a specially conceived version available that fulfils all the necessary safety requirements. Used in a module sense, individual solutions are no problem at all.

The CEAG wall socket for instance can be mounted on to the pre-installed mounting frame without having to use tools – installation without a hot work permit.

Apart from the plugs and receptacles for the European market, we also have plugs and sockets extra for the US market, which are in accordance to all of the necessary standards UL and safety protection systems used there. The available standard range used here, are the 20 A, 30 A, 60 A and 100 A.

## **International approvals.**

**Safety standard IP66 applies also in the plugged-in state**

**Full AC-3 switching ability**

**Self-cleaning lamellar contacts, low transition resistance**

**All-pole on/off switching**

**Easy plugging**



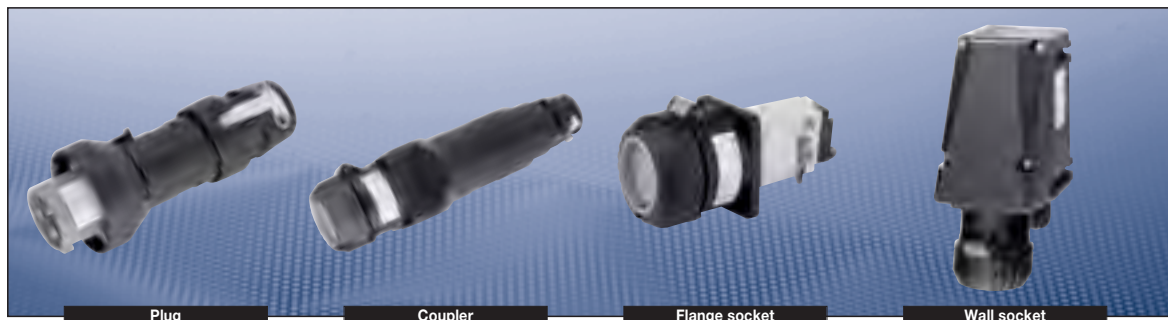

Technical data

Ex-plugs and receptacles accd. to IEC 60309-1/2 16A

Marking to 94/9/EC	II 3 G Ex nC IIC T5/T6
EC-Type Examination Certificate	PTB 99 ATEX 1115
Permissible ambient temperature	-20°C to +40°C <sup>1)</sup>
Rated voltage	up to 400 V (3-pole) / 750 V (4-pole) / 500 V (5-pole) (AC)
Rated current	up to 16 A
Frequency	up to 400 Hz
Rated making/rated breaking capacity AC-3 accd. EN 60947-3	U <sub>e</sub> 400 V / I <sub>e</sub> 16 A
External back-up fuse, max.	without therm. protection: 16 A with therm. protection: 35 A gL (rated current 16 A set to)
Insulation class	I
Degree of protection to EN 60529	IP66

Wall socket

Cable glands	1 x M25 Ø 8 - 17 mm, 1 x M25 Ex-screw plug plastic or 2 x metal thread M20 with Ex-screw plug plastic
Connecting terminals	2 x 1.5 - 4 mm <sup>2</sup>
Enclosure material	Glass-fibre reinforced polyester

Plug

Cable glands	Ø 8 - 19 mm (3-pole) / Ø 8 - 21 mm (4-pole) / 12 - 21 mm (5-pole)
Connecting terminals	1 x 1.0 - 2.5 mm <sup>2</sup>
Enclosure material	Polyamide

Coupler

Cable glands	Ø 8 - 19 mm (3-pole) / Ø 8 - 21 mm (4-pole) / 12 - 21 mm (5-pole)
Connecting terminals	2 x 1.5 - 4 mm <sup>2</sup>
Enclosure material	Polyamide

Flange socket

Connecting terminals	2 x 1 - 4 mm <sup>2</sup>
Enclosure material	Polyamide

<sup>1)</sup> extended temperature range on request

**| Zone 2: 16A 3-pole, 4-pole and 5-pole up to 690 V |**

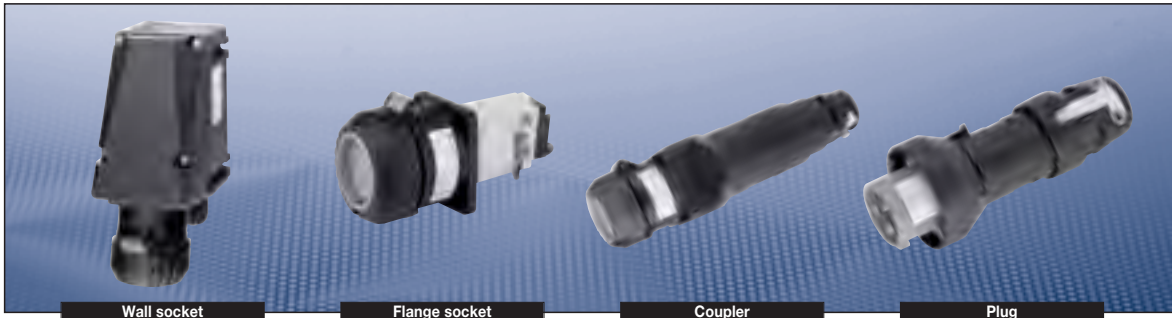

**Ordering details**

Voltage	h	Type	Cable entry	Weight approx.	Order No.
<b>Type 16 A 3-pole</b>					
110-130 V		Wall socket	KU	1.2 kg	<b>GHG 516 4304 R0001</b>
		Wall socket	ME	1.3 kg	<b>GHG 516 4304 R3001</b>
		Flange socket		0.4 kg	<b>GHG 516 8304 R0001</b>
		Coupler		0.7 kg	<b>GHG 516 3304 R0001</b>
		Plug		0.35 kg	<b>GHG 516 7304 R0001</b>
200-250 V		Wall socket	KU	1.2 kg	<b>GHG 516 4306 R0001</b>
		Wall socket	ME	1.3 kg	<b>GHG 516 4306 R3001</b>
		Flange socket		0.4 kg	<b>GHG 516 8306 R0001</b>
		Coupler		0.7 kg	<b>GHG 516 3306 R0001</b>
		Plug		0.35 kg	<b>GHG 516 7306 R0001</b>
<b>Type 16 A 4-pole</b>					
200-250 V		Wall socket	KU	1.8 kg	<b>GHG 516 4409 R0001</b>
		Wall socket	ME	1.9 kg	<b>GHG 516 4409 R3001</b>
		Flange socket		1.0 kg	<b>GHG 516 8409 R0001</b>
		Coupler		1.7 kg	<b>GHG 516 3409 R0001</b>
		Plug		0.7 kg	<b>GHG 516 7409 R0001</b>
380-415 V		Wall socket	KU	1.8 kg	<b>GHG 516 4406 R0001</b>
		Wall socket	ME	1.9 kg	<b>GHG 516 4406 R3001</b>
		Flange socket		1.0 kg	<b>GHG 516 8406 R0001</b>
		Coupler		1.7 kg	<b>GHG 516 3406 R0001</b>
		Plug		0.7 kg	<b>GHG 516 7406 R0001</b>
480-500 V		Wall socket	KU	1.8 kg	<b>GHG 516 4407 R0001</b>
		Wall socket	ME	1.9 kg	<b>GHG 516 4407 R3001</b>
		Flange socket		1.0 kg	<b>GHG 516 8407 R0001</b>
		Coupler		1.7 kg	<b>GHG 516 3407 R0001</b>
		Plug		0.7 kg	<b>GHG 516 7407 R0001</b>
600-690 V		Wall socket	KU	1.8 kg	<b>GHG 516 4405 R0001</b>
		Wall socket	ME	1.9 kg	<b>GHG 516 4405 R3001</b>
		Flange socket		1.0 kg	<b>GHG 516 8405 R0001</b>
		Coupler		1.7 kg	<b>GHG 516 3405 R0001</b>
		Plug		0.7 kg	<b>GHG 516 7405 R0001</b>
<b>Type 16 A 5-pole</b>					
200-250 V		Wall socket	KU	1.8 kg	<b>GHG 516 4506 R0001</b>
380-415 V		Wall socket	ME	1.9 kg	<b>GHG 516 4506 R3001</b>
		Flange socket		1.0 kg	<b>GHG 516 8506 R0001</b>
		Coupler		1.7 kg	<b>GHG 516 3506 R0001</b>
		Plug		0.7 kg	<b>GHG 516 7506 R0001</b>

Other voltage ranges and versions for example with auxiliary contact available on request

KU = 1 x plastic cable glands M25 Ø 8-17 mm, 1 x M25 Ex-screw plug plastic

ME = 2 x metal thread M20 with Ex-screw plug plastic

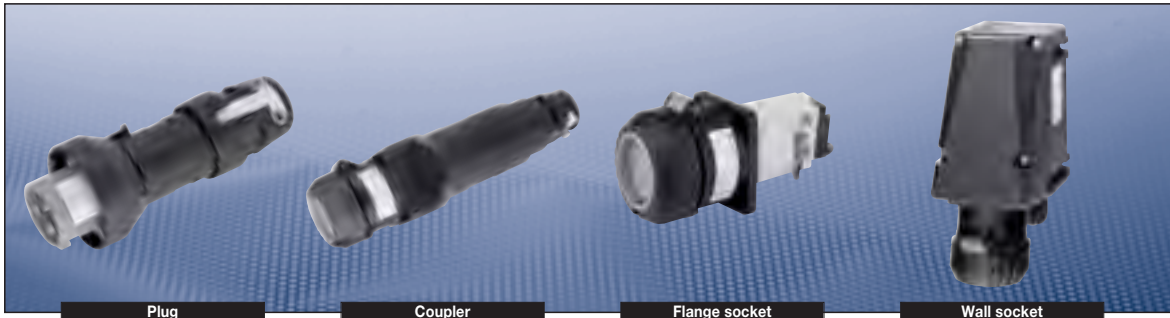

**Dimension drawing | Wiring diagram**

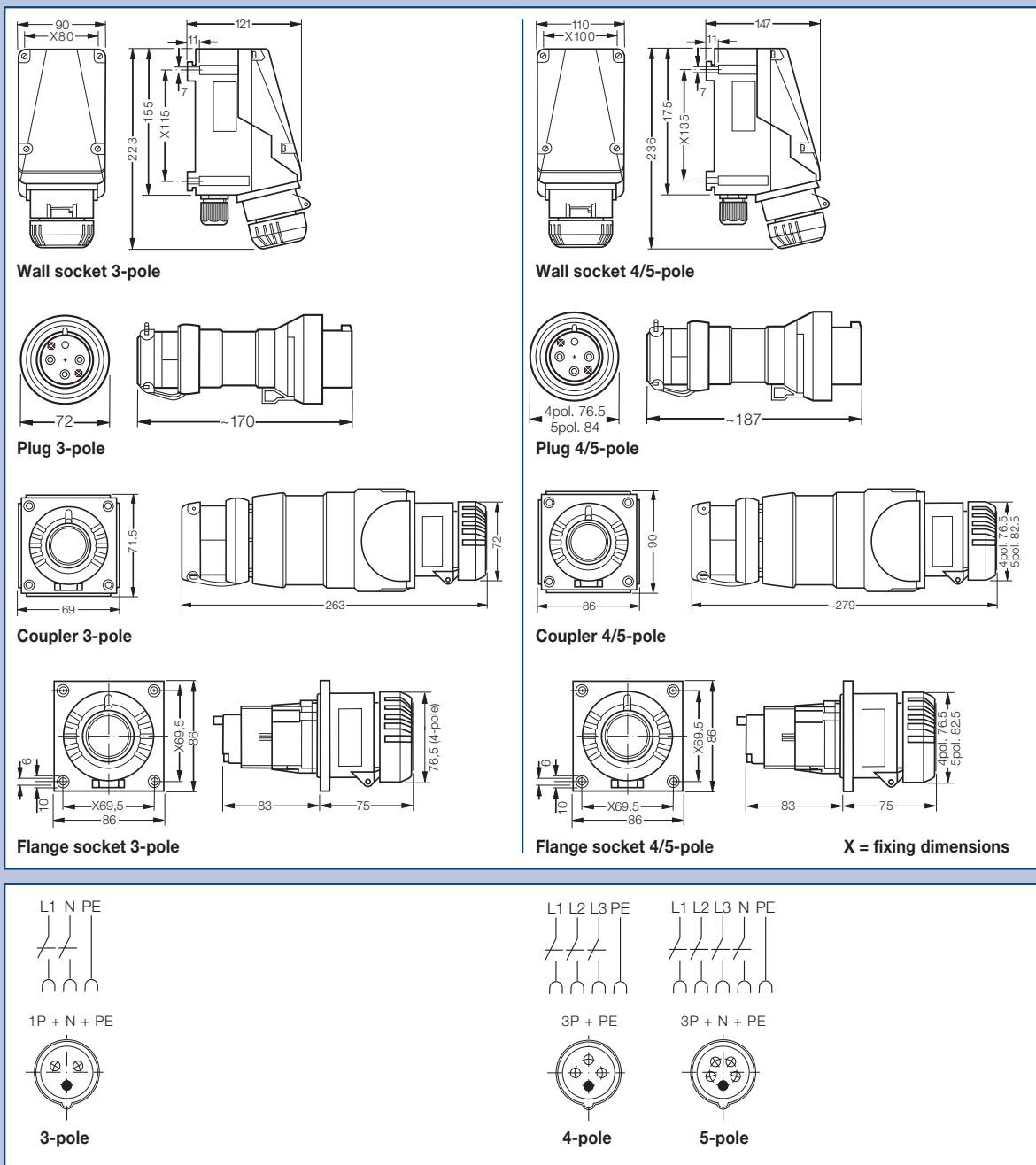

Dimensions in mm

1  
2  
3  
4  
5  
6  
7  
8  
9  
10  
11  
12



**| Zone 2: 16A 3-pole, 4-pole and 5-pole up to 690 V |**

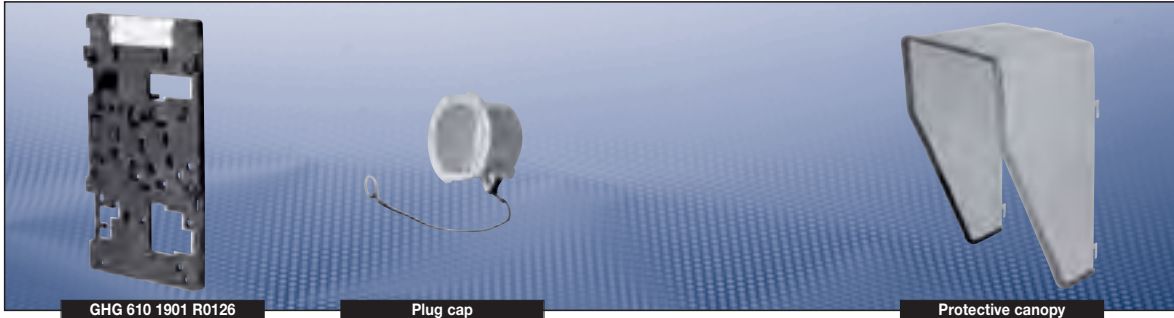

GHG 610 1901 R0126

Plug cap

Protective canopy

**Accessories**

**Mounting plates for wall sockets 16 A**

Type	Application	Fixing method	Order No.
Size 4	for wall mounting	snap on	GHG 610 1953 R0126
Size 4	for trellis mounting	snap on	GHG 610 1953 R0126
Size 4	for pipe mounting	snap on	GHG 610 1953 R0130

**Plug cap for plugs 16 A**

Type	Order No.
Plug 16 A 3-pole	GHG 510 1901 R0001
Plug 16 A 4-pole	GHG 510 1901 R0002
Plug 16 A 5-pole	GHG 510 1901 R0003

**Accessories for mounting plates**

Type	OU	Order No.
Mounting set for pipes 1" (Ø 27 - 30 mm) for mounting plates with pipe fixing	10	GHG 610 1953 R0020

Please pay attention that only order units (OU) according to the ordering details can be delivered.

**Protective canopy for mounting plate**

Type	Application	Order No.
Size 4	for mounting plate size 4, plugable	GHG 610 1955 R0107

**Dimension drawing**

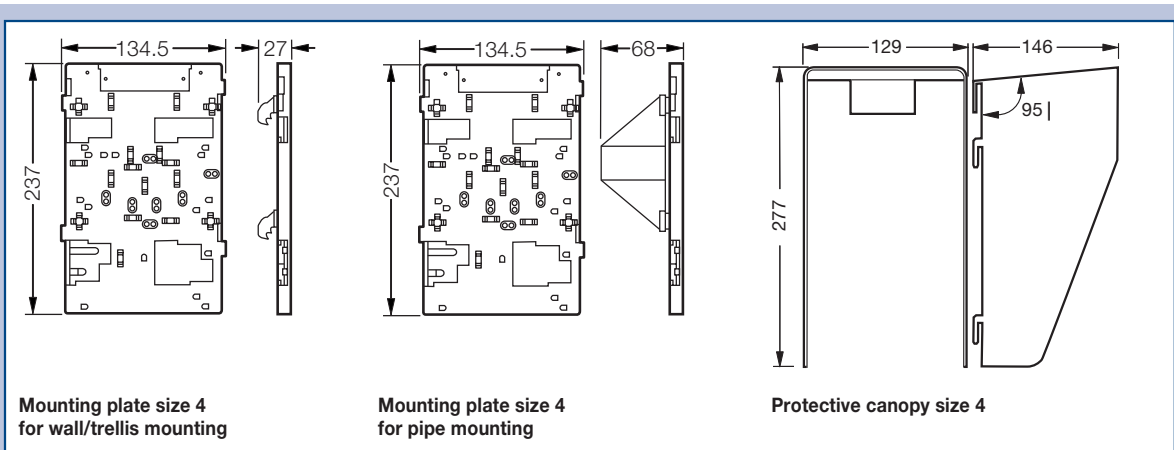

Mounting plate size 4 for wall/trellis mounting

Mounting plate size 4 for pipe mounting

Protective canopy size 4

Dimensions in mm

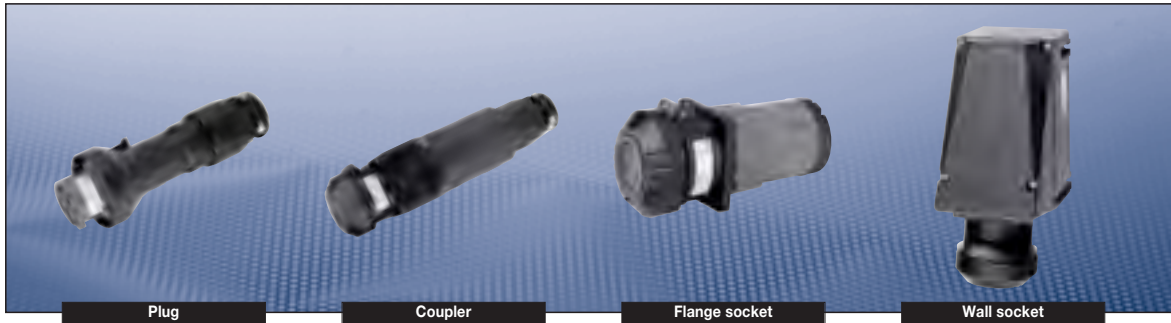

## Technical data

### Ex-plugs and receptacles accd. to IEC 60309-1/2

Marking to 94/9/EC	Ⓔ II 3 G Ex nC IIC T6
EC-Type Examination Certificate	PTB 99 ATEX 1115
Permissible ambient temperature	-20 °C to +40 °C <sup>1)</sup>
Rated voltage	690 V (AC)
Rated current	up to 32 A
Frequency	up to 400 Hz
Rated making/rated breaking capacity AC-3 accd. EN 60947-3	U <sub>e</sub> 690 V / I <sub>e</sub> 32 A
External back-up fuse	without therm. protection: 35 A with therm. protection: 50 A gL (rated current 32 A set to)
Insulation class	I
Degree of protection accd. EN 60529	IP66
Enclosure colour	Black

### Wall socket

Cable glands/enclosure drilling	1 x M40 Ø 17 - 28 mm, 1 x M40 Ex-screw plug plastic or 2 x M32 metal thread with 2 Ex-screw plug plastic
Connecting terminals	2 x 4 - 10 mm <sup>2</sup>
Enclosure material	Glass-fibre reinforced polyester

### Plug

Cable glands	Ø 17 - 28 mm
Connecting terminals	1 x 1.0 - 6 mm <sup>2</sup>
Enclosure material	Polyamide

### Coupler

Cable glands	Ø 17 - 28 mm
Connecting terminals	2 x 4 - 10 mm <sup>2</sup>
Enclosure material	Polyamide

### Flange socket

Connecting terminals	2 x 4 - 10 mm <sup>2</sup>
Enclosure material	Polyamide

<sup>1)</sup> extended temperature range on request



**| Zone 2: 32A 4-pole and 5-pole up to 690 V |**

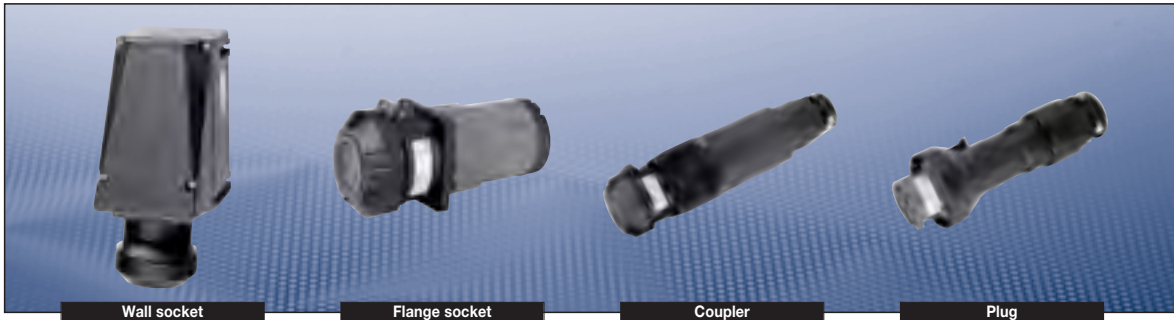

**Ordering details**

Voltage	h	Type	Cable entries	Weight approx.	Order No.
<b>Type 32 A 4-pole</b>					
200-250 V		Wall socket	KU	1.8 kg	<b>GHG 517 4409 R0001</b>
		Wall socket	ME	1.9 kg	<b>GHG 517 4409 R3001</b>
		Flange socket		1.0 kg	<b>GHG 517 8409 R0001</b>
		Coupler		1.7 kg	<b>GHG 517 3409 R0001</b>
		Plug		0.7 kg	<b>GHG 517 7409 R0001</b>
380-415 V		Wall socket	KU	1.8 kg	<b>GHG 517 4406 R0001</b>
		Wall socket	ME	1.9 kg	<b>GHG 517 4406 R3001</b>
		Flange socket		1.0 kg	<b>GHG 517 8406 R0001</b>
		Coupler		1.7 kg	<b>GHG 517 3406 R0001</b>
		Plug		0.7 kg	<b>GHG 517 7406 R0001</b>
480-500 V		Wall socket	KU	1.8 kg	<b>GHG 517 4407 R0001</b>
		Wall socket	ME	1.9 kg	<b>GHG 517 4407 R3001</b>
		Flange socket		1.0 kg	<b>GHG 517 8407 R0001</b>
		Coupler		1.7 kg	<b>GHG 517 3407 R0001</b>
		Plug		0.7 kg	<b>GHG 517 7407 R0001</b>
600-690 V		Wall socket	KU	1.8 kg	<b>GHG 517 4405 R0001</b>
		Wall socket	ME	1.9 kg	<b>GHG 517 4405 R3001</b>
		Flange socket		1.0 kg	<b>GHG 517 8405 R0001</b>
		Coupler		1.7 kg	<b>GHG 517 3405 R0001</b>
		Plug		0.7 kg	<b>GHG 517 7405 R0001</b>

<b>Type 32 A 5-pole</b>					
200-250 V		Wall socket	KU	1.8 kg	<b>GHG 517 4506 R0001</b>
380-415 V		Wall socket	ME	1.9 kg	<b>GHG 517 4506 R3001</b>
		Flange socket		1.0 kg	<b>GHG 517 8506 R0001</b>
		Coupler		1.7 kg	<b>GHG 517 3506 R0001</b>
		Plug		0.7 kg	<b>GHG 517 7506 R0001</b>

Other voltage ranges and versions with auxiliary contact available on request

KU = 1 x plastic cable glands M40 Ø 17-28 mm, 1 x M40 Ex-screw plug plastic

ME = 2 x metal thread M32 with Ex-screw plug plastic

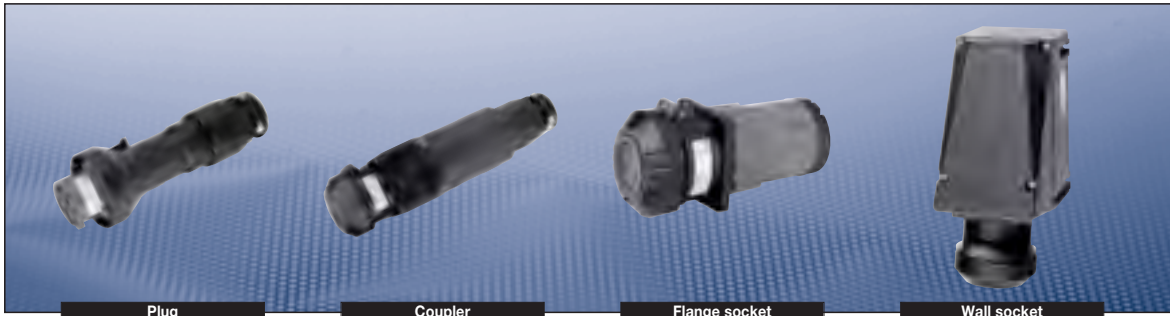

Plug

Coupler

Flange socket

Wall socket

**Dimension drawing | Wiring diagram**

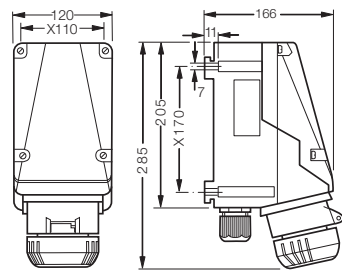

Wall socket 4-pole

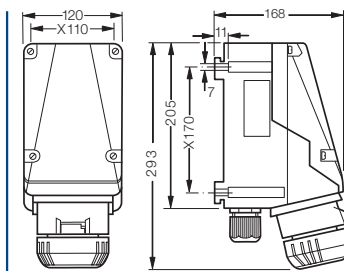

Wall socket 5-pole

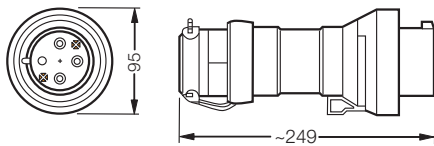

Plug 4-pole

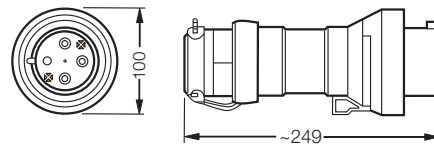

Plug 5-pole

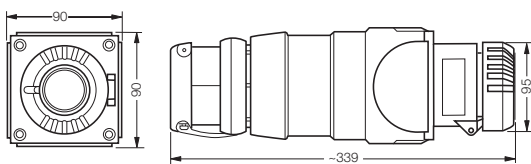

Coupler 4-pole

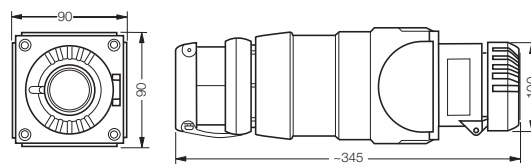

Coupler 5-pole

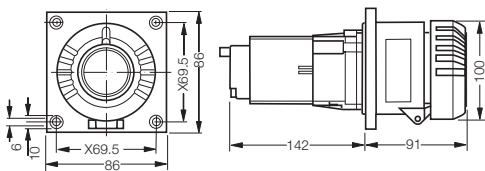

Flange socket 4-pole

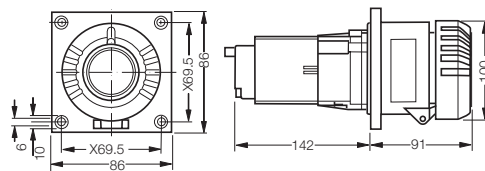

Flange socket 5-pole

X = fixing dimensions

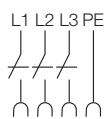

3P + PE

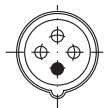

4-pole

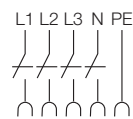

3P + N + PE

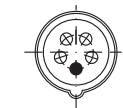

5-pole

Dimensions in mm

1  
2  
3  
4  
5  
6  
7  
8  
9  
10  
11  
12

**Zone 2: 32A 4-pole and 5-pole up to 690 V**

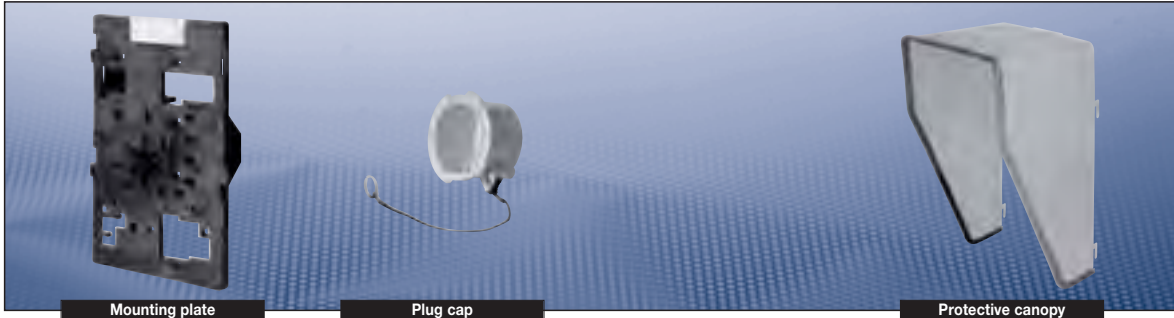

Mounting plate

Plug cap

Protective canopy

**Accessories**

**Mounting plates for wall sockets 32 A**

Type	Application	Fixing method	Order No.
Size 5	for wall mounting	snap on	<b>GHG 610 1953 R0128</b>
Size 5	for trellis mounting	snap on	<b>GHG 610 1953 R0128</b>
Size 5	for pipe mounting	snap on	<b>GHG 610 1953 R0132</b>

**Plug cap for plugs 32 A**

Type	Order No.
Plug 32 A 3-pole/4-pole	<b>GHG 510 1901 R0004</b>
Plug 32 A 5-pole	<b>GHG 510 1901 R0005</b>

**Accessories for mounting plates**

Type	OU	Order No.
Mounting set for pipes 1" (Ø 27 - 30 mm) for mounting plates with pipe fixing	10	<b>GHG 610 1953 R0020</b>

Please pay attention that only order units (OU) according to the ordering details can be delivered.

**Protective canopy for mounting plate**

Type	Application	Order No.
Size 5	for mounting plate size 5 plugable	<b>GHG 610 1955 R0108</b>

**Dimension drawing**

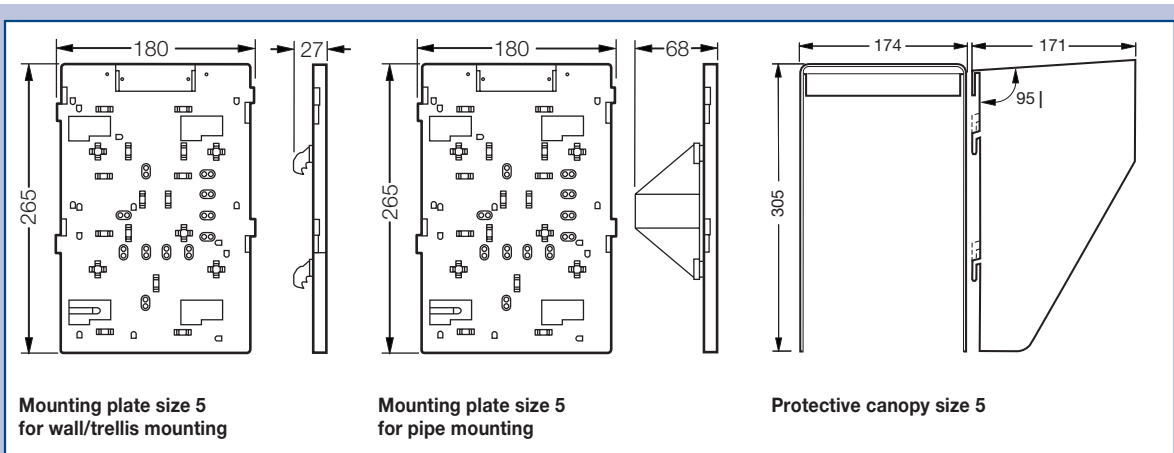

Mounting plate size 5 for wall/trellis mounting

Mounting plate size 5 for pipe mounting

Protective canopy size 5

Dimensions in mm

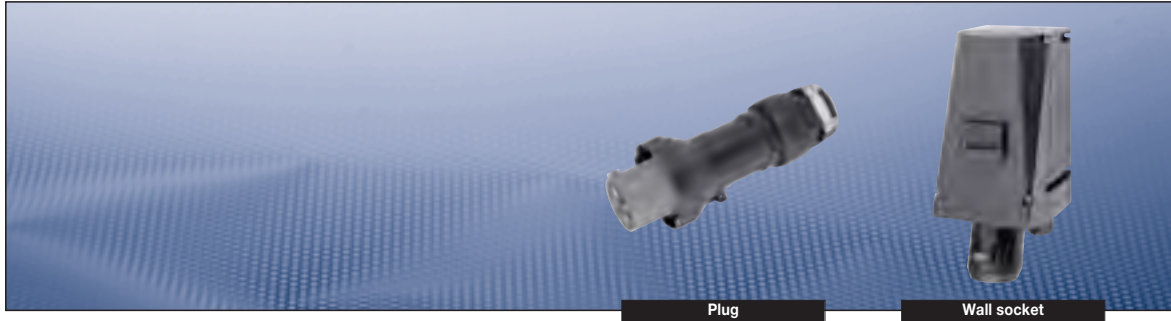

## Technical data

### Ex-plugs and receptacles accd. to IEC 60309-1/2 up to 690 V

Marking to 94/9/EC	Ⓔ II 3 G Ex nC IIC T6
EC-Type Examination Certificate	PTB 99 ATEX 1115
Permissible ambient temperature	-20 °C to + 40 °C <sup>1)</sup>
Rated voltage	690 V
Rated current	63 A
Frequency	up to 400 Hz
Rated making/rated breaking capacity AC-3 accd. EN 60947-3	$U_e$ 690 V / $I_e$ 63 A
External back up fuse	without therm. protection: 63 A with therm. protection: 80 A gL (rated current 63 A set to)
Insulation class	I
Degree of protection accd. EN 60529	IP66
Enclosure colour	Black

### Wall socket

Cable glands/enclosure drilling	1 x M50 Ø 22 - 35 mm, 1 x M50 Ex-screw plug plastic or 2 x M40 metal thread with Ex-screw plug plastic
Connecting terminals	2 x 4 - 25 mm <sup>2</sup> / with cable lug <sup>1)</sup> 1 x 35 mm <sup>2</sup>
Enclosure material	Glass-fibre reinforced polyester

### Plug

Cabel glands	Ø 19 - 34 mm
Connecting terminals	1 x 4 - 16 mm <sup>2</sup> / with cable lug 1 x 25 mm <sup>2</sup>
Enclosure material	Polyamide

<sup>1)</sup> extended temperature range on request



**| Zone 2: 63 A 4- and 5-pole up to 690 V |**

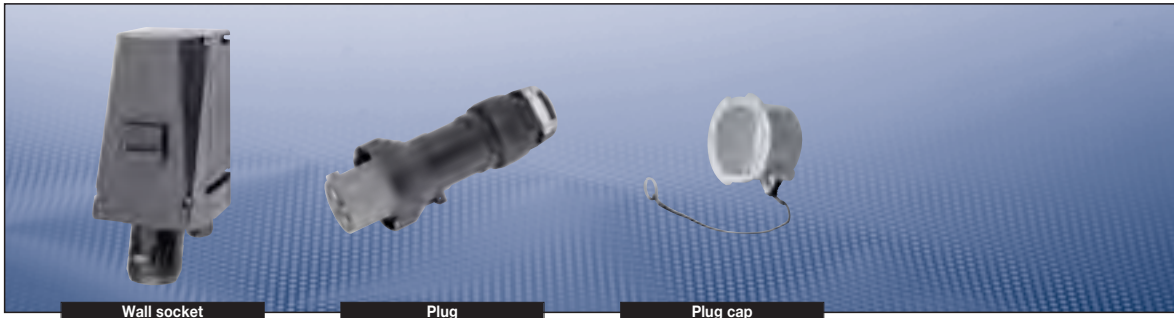

**Ordering details**

Voltage	h	Type	Cable entries	Weight approx.	Order No.
<b>Type 63 A 4-pole</b>					
200-250 V		Wall socket	KU	8.1 kg	<b>GHG 518 4409 R0001</b>
		Wall socket	ME	8.2 kg	<b>GHG 518 4409 R3001</b>
		Plug		0.75 kg	<b>GHG 518 7409 R0001</b>
380-415 V		Wall socket	KU	8.1 kg	<b>GHG 518 4406 R0001</b>
		Wall socket	ME	8.2 kg	<b>GHG 518 4406 R3001</b>
		Plug		0.75 kg	<b>GHG 518 7406 R0001</b>
480-500 V		Wall socket	KU	8.1 kg	<b>GHG 518 4407 R0001</b>
		Wall socket	ME	8.2 kg	<b>GHG 518 4407 R3001</b>
		Plug		0.75 kg	<b>GHG 518 7407 R0001</b>
600-690 V		Wall socket	KU	8.1 kg	<b>GHG 518 4405 R0001</b>
		Wall socket	ME	8.2 kg	<b>GHG 518 4405 R3001</b>
		Plug		0.75 kg	<b>GHG 518 7405 R0001</b>
<b>Type 63 A 5-pole</b>					
200-250 V		Wall socket	KU	8.15 kg	<b>GHG 518 4506 R0001</b>
380-415 V		Wall socket	ME	8.25 kg	<b>GHG 518 4506 R3001</b>
		Plug		0.75 kg	<b>GHG 518 7506 R0001</b>

**Accessories**

**Plug cap for plugs**

Type	OU	Order No.
Plug cap 4-pole/5-pole	1	<b>GHG 510 1901 R0006</b>
Pin cable lug 25 mm <sup>2</sup>	5	<b>GHG 510 1916 R0001</b>

Other voltage ranges and versions with auxiliary contact available on request

KU = 1 x plastic cable glands M40 Ø 17-28 mm, 1 x M40 Ex-screw plug plastic

ME = 2 x metal thread M32 with Ex-screw plug plastic

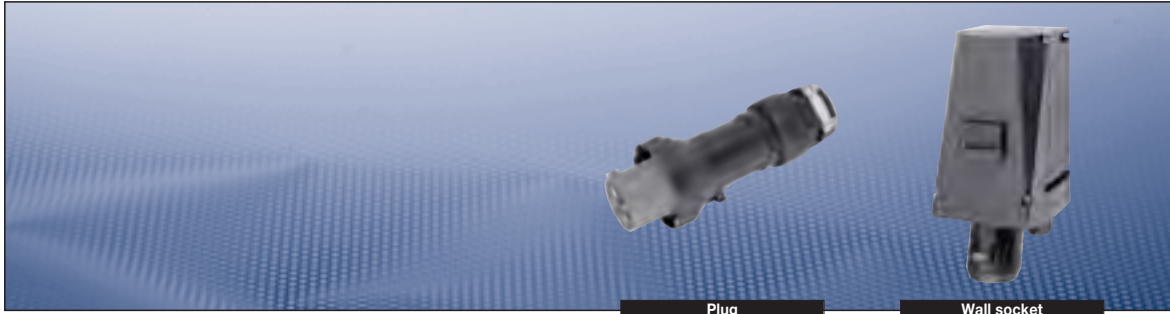

Plug

Wall socket

Dimension drawing | Wiring diagram

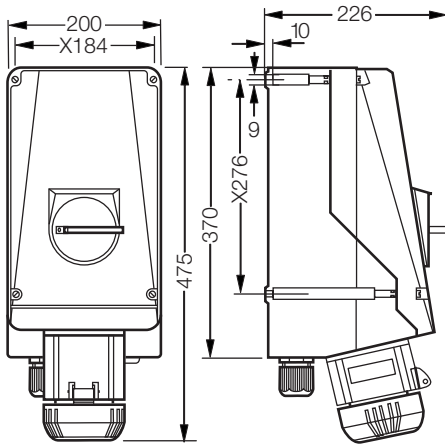

Wall socket 4/5-pole

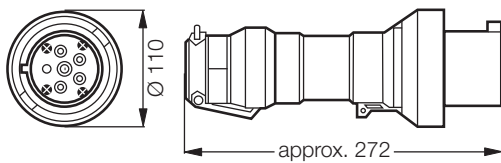

Plug 4/5-pole

X = mounting dimensions

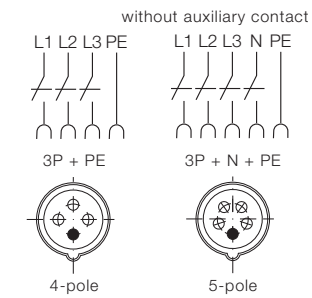

Dimensions in mm

1  
2  
3  
4  
5  
6  
7  
8  
9  
10  
11  
12

**| Zone 2: 125A 4- and 5-pole up to 690 V |**

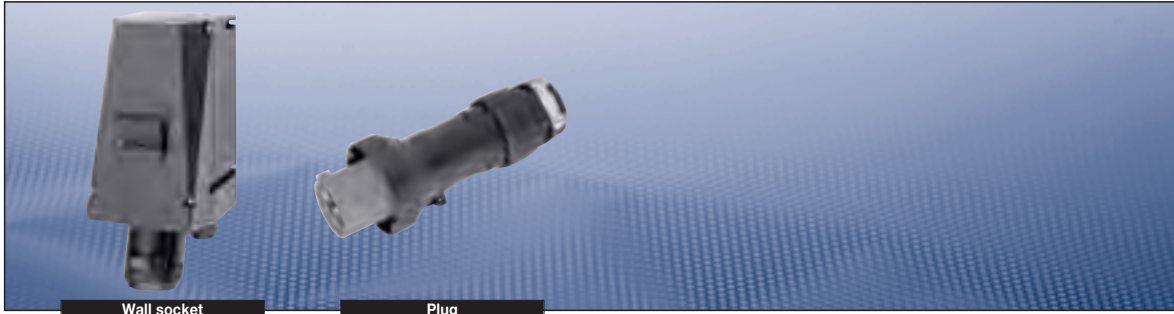

**Technical data**

**Ex-plugs and receptacles accd. to IEC 60309-1/2 to 690 V**

Marking to 94/9/EC	Ⓔ II 3 G EX de IIC T6
EC-Type Examination Certificate	PTB 99 ATEX 1115
Permissible ambient temperature	-20 °C to + 40 °C <sup>1)</sup>
Rated voltage	690 V
Rated current	125 A
Frequency	up to 400 Hz
Rated making/rated breaking capacity AC-3 accd. EN 60947-3	U <sub>e</sub> 690 V / I <sub>e</sub> 125 A
External back up fuse	without therm. protection: 125 A with therm. protection: 160 A gL (rated current 125 A set to)
Insulation class	I
Degree of protection accd. EN 60529	IP66
Enclosure colour	Black

**Wall socket**

Cable glands/enclosure drilling	1 x M63 Ø 27 - 48 mm, 1 x M63 Ex-screw plug plastic or 1 x M50 Ø 21 - 35 mm, 1 x M50 Ex-screw plug plastic
Connecting terminals	2 x 4 - 50 mm <sup>2</sup> / with cable lug <sup>1)</sup> 1 x 120 mm <sup>2</sup>
Enclosure material	Glass-fibre reinforced polyester

**Plug**

Cabel glands	Ø 31 - 58 mm
Connecting terminals	1 x 4 - 35 mm <sup>2</sup> / with pin cable lug 1 x 50 mm <sup>2</sup>
Enclosure material	Polyamide

<sup>1)</sup> extended temperature range on request

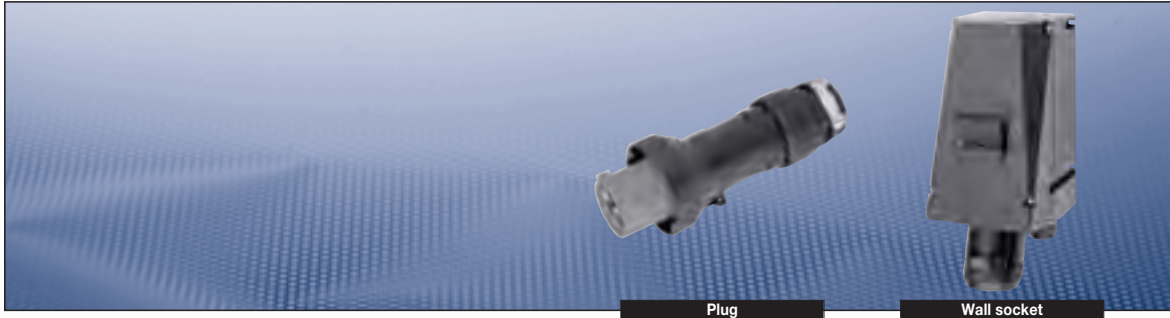

### Ordering details

Voltage	h	Type	Cable entry	Weight approx.	Order No.
<b>Type 125 A 4-pole</b>					
200-250 V		Wall socket	KU	12.3 kg	<b>GHG 519 4409 R0001</b>
		Wall socket	ME	12.5 kg	<b>GHG 519 4409 R3001</b>
		Plug		0.9 kg	<b>GHG 519 7409 R0001</b>
380-415 V		Wall socket	KU	12.3 kg	<b>GHG 519 4406 R0001</b>
		Wall socket	ME	12.5 kg	<b>GHG 519 4406 R3001</b>
		Plug		0.9 kg	<b>GHG 519 7406 R0001</b>
480-500 V		Wall socket	KU	12.3 kg	<b>GHG 519 4407 R0001</b>
		Wall socket	ME	12.5 kg	<b>GHG 519 4407 R3001</b>
		Plug		0.9 kg	<b>GHG 519 7407 R0001</b>
600-690 V		Wall socket	KU	12.3 kg	<b>GHG 519 4405 R0001</b>
		Wall socket	ME	12.5 kg	<b>GHG 519 4405 R3001</b>
		Plug		0.9 kg	<b>GHG 519 7405 R0001</b>

<b>Type 125 A 5-pole</b>					
200-250 V		Wall socket	KU	13 kg	<b>GHG 519 4506 R0001</b>
380-415 V		Wall socket	ME	13.2 kg	<b>GHG 519 4506 R3001</b>
		Plug		1.2 kg	<b>GHG 519 7506 R0001</b>

### Accessories

Type	OU	Order No.
Plug cap 4-pole/5-pole	1	<b>GHG 510 1901 R0007</b>
Cable lug 50 mm <sup>2</sup>	5	<b>GHG 260 1911 R0004</b>

Other voltage ranges and versions with auxiliary contact available on request

KU = 1 x plastic cable glands M40 Ø 17-28 mm, 1 x M40 Ex-screw plug plastic

ME = 2 x metal thread M32 with Ex-screw plug plastic



**| Zone 2: 125A 4- and 5-pole up to 690 V |**

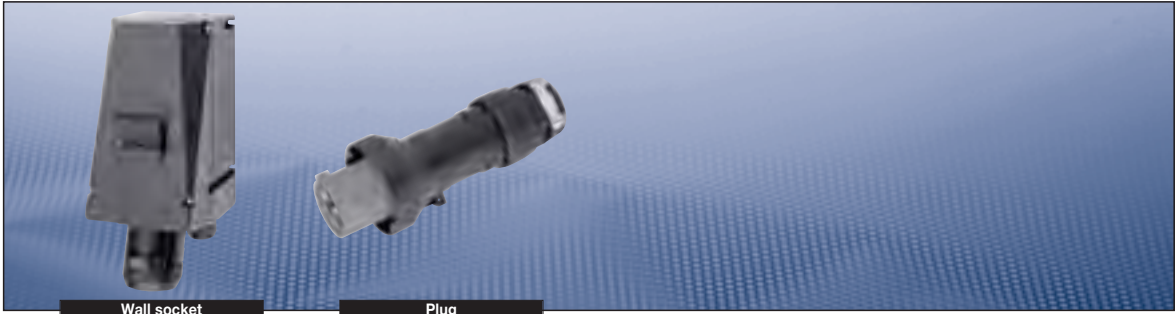

Wall socket

Plug

**Dimension drawing | Wiring diagram**

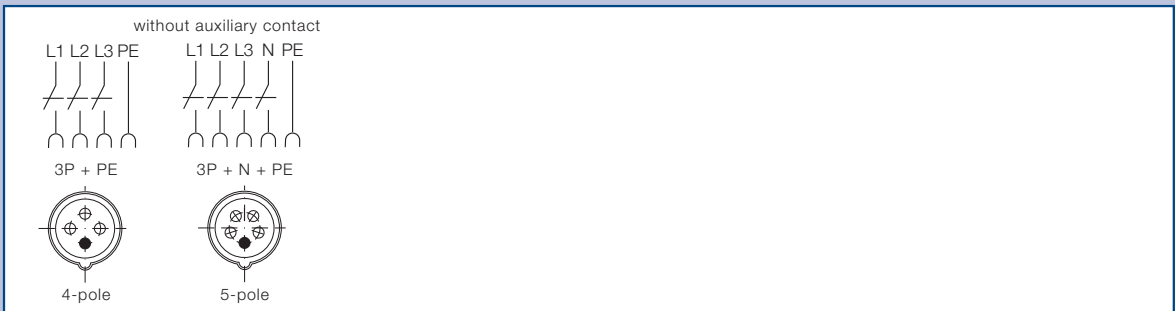
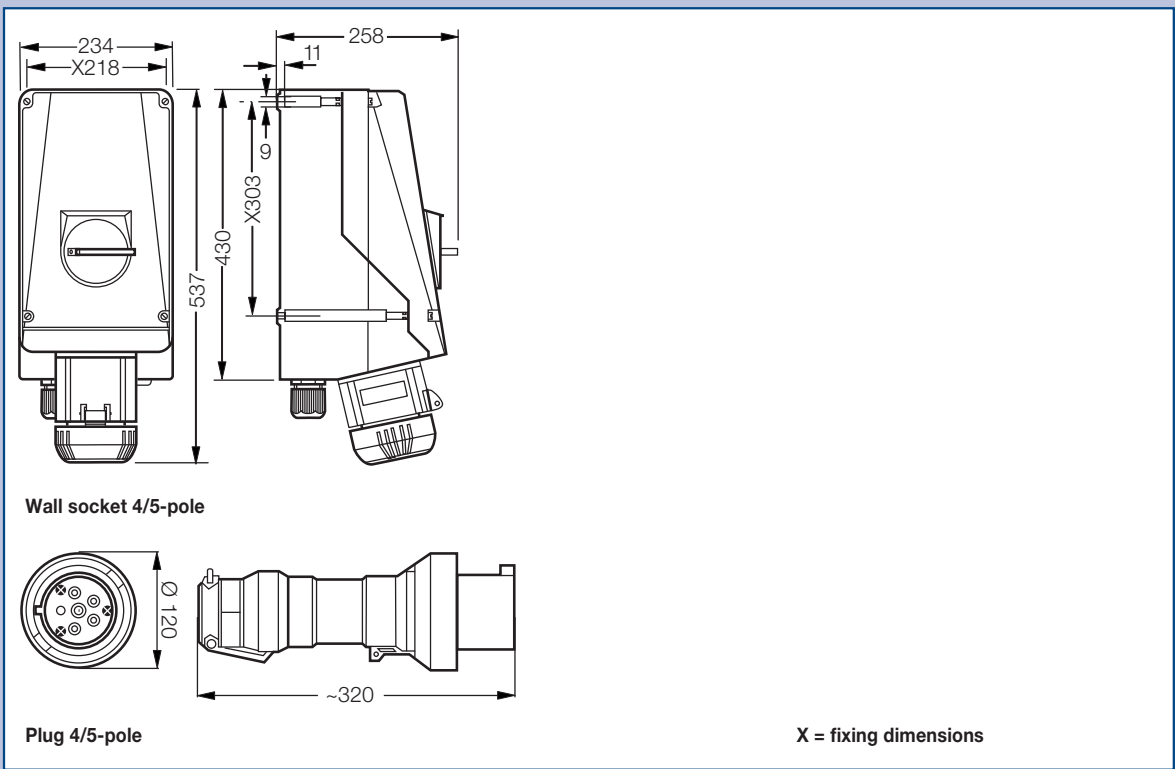

Dimensions in mm